

Dimensions
In(mm)

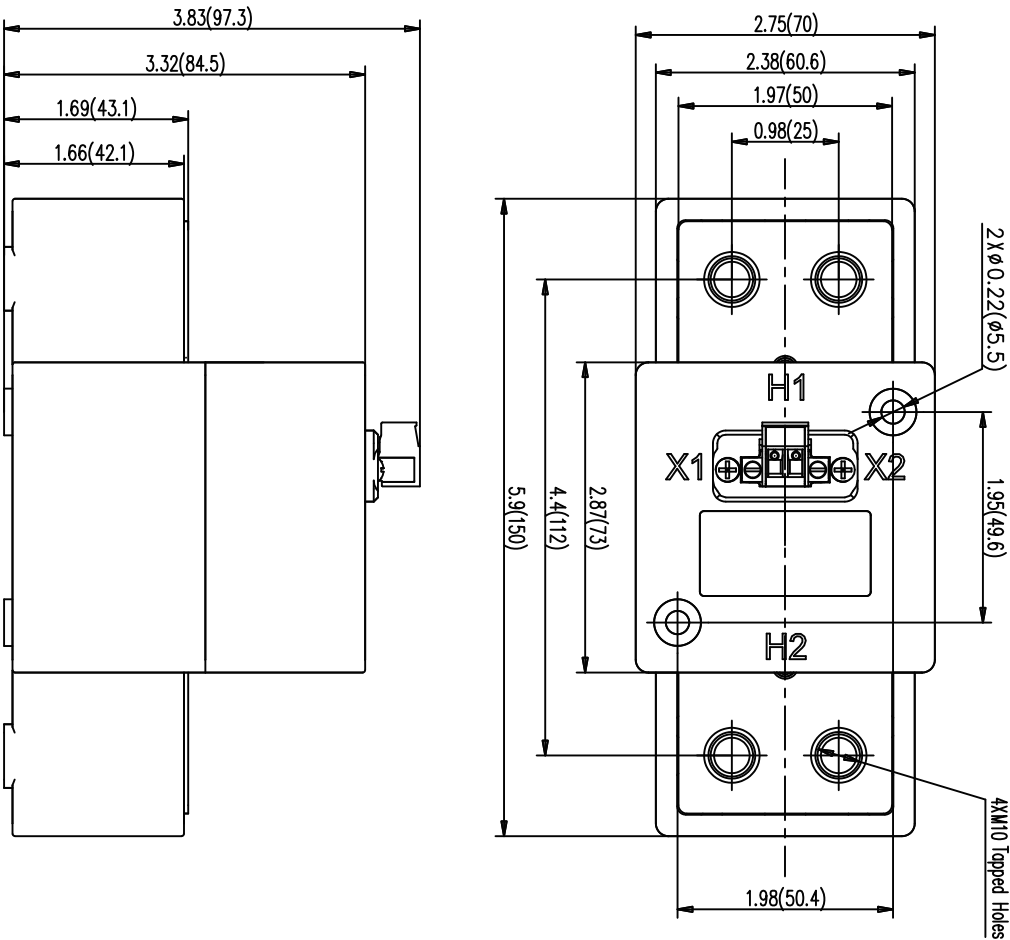

Specifications:

NCS26N

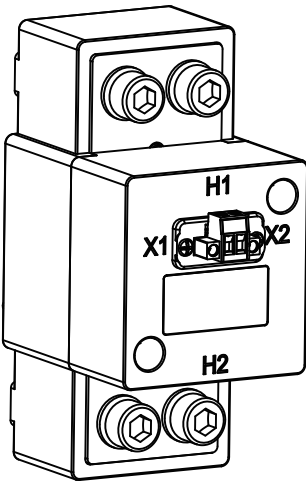

Neutral Current Sensor

Primary current input	Secondary voltage output
800A	110mV
1000A	137.5mV
1200A	165mV

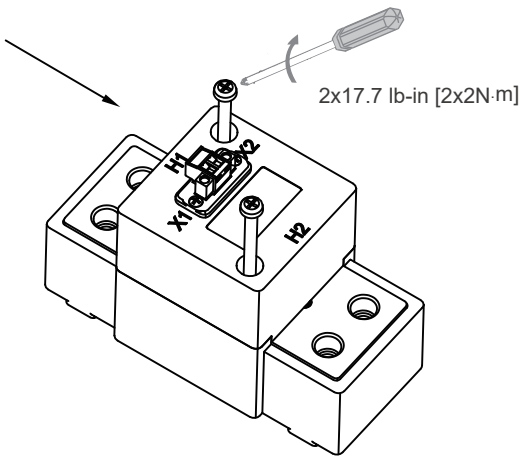

Installation of NCS26N

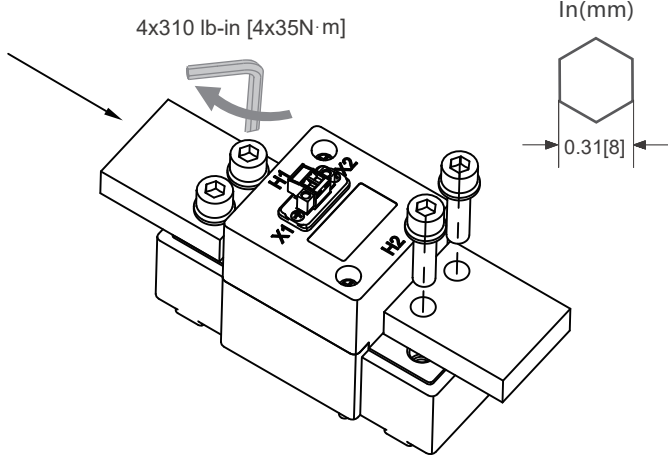

Connection of the Neutral

Note:

1. The connection between the neutral and NCS26N polarity must be correct: H1 must be connected with LINE side, H2 with LOAD side ;
2. The signal wiring terminals of NCS26N - X1 and X2 - must be connected to corresponding terminals on the specific circuit breaker - M6 3P4W and is not reversible.

Main circuit feed direction

LINE

LOAD

NCS26N

M6-3P4W

Note:

1. Signal wire is not included in NCS26N products;
2. The gauge of the signal wire should be within 14 AWG to 24 AWG.

